

Note that all unique customer requirements (i.e tolerance) need to be verified thru Alfa Laval.

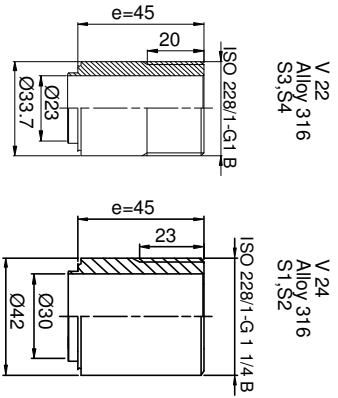
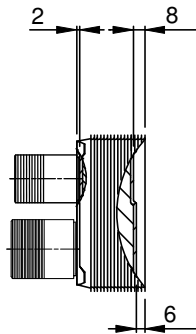
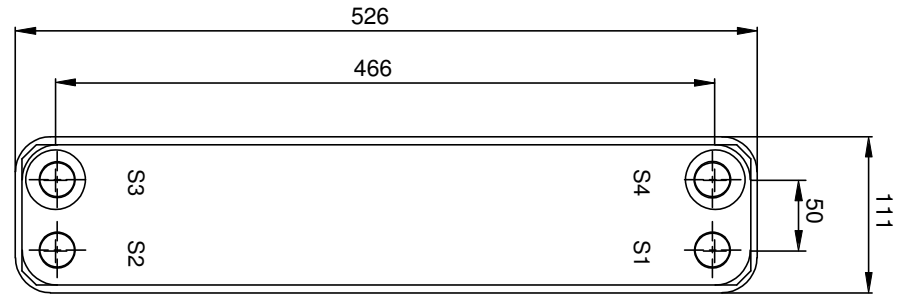
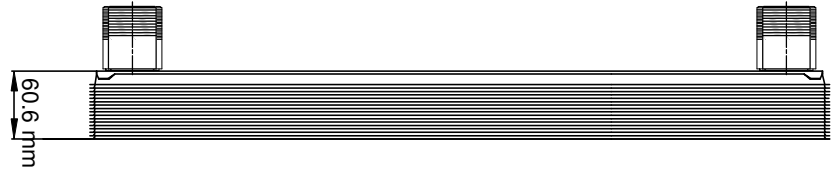

Frameplate is depressed 2 mm at connection S3/S4
 Pressureplate is depressed 2 mm / even number of channel plates
 att connections T3/T4 / uneven number of channel plates att
 connections T1/T2.

T1 T2 T3 T4 locations on back side
 correspond to S1 S2 S3 S4 on front side

WSZYSTKIE WYMIARY W MILIMETRACH

HEATING SURFACE 0.9180 m² MATERIAL PLYT Alloy 316
 WAGA NETTO. 7.484 kg
 CIEZAR ROBOCZY 9.273 kg ZESTAWIENIE 1*9H / 1*10H
 DŁUG. 105.6
 SZER. 111.0
 WYS. 526.0

MEDIA	Wlot	TEMP.	WYLOT.	TEMP.	PRZEPLYW	SPADEK CISNIENIA	OBJENT. CIECZ
Water	S1	70.0 °C	S2	25.0 °C	1.4 m ³ /h	11.77 kPa	0.9500 dm ³
Water	S3	5.0 °C	S4	55.0 °C	1.2 m ³ /h	11.81 kPa	0.8550 dm ³

DOSTAWCA	WZORZEC	TONO..
CZYNNIK / WZORZEC		
KLIENT		
WYK.		

PLYTOWY WYMIENNIK CIEPLA.
AlfaNova 52-20H
 PED

ITEM ID.
32880 0113 9
 DATA
2016-11-18
 OBRÓTY
NR.: 0